

## TECHNICAL SPECIFICATIONS

### ANALYTICAL MODES

Manual, Predilute, Capillary

### TOTAL PARAMETERS

32 : WBC, RBC, HGB, HCT, MCV, MCH, MCHC, RDW-CV, RDW-SD, PLT, MPV, PDW-CV, PDW-SD, PCT, P-LCR, P-LCC, NEU%, Lymph %, Mon%, Eos%, Bas%, Neu#, Lym#, Mon#, Eos#, Bas#, ALY%\*, LIC%\*, ALY#\*, LIC#\*, NRBC%\*, NRBC#\*

### PRINCIPLE OF MEASUREMENT

RBC/PLT/WBC: Electrical Impedance  
DIFF: 3 Angle Laser Flow Cytometry  
HGB: Cyanide Free Colorimetry  
MCV: Measured  
HCT: Calculated

### GRAPHICS

3 Histograms(WBC/RBC/PLT)  
4 Scatterplots(DIFF x3, BASO)

### SAMPLE VOLUME

Whole Blood : 15 µl  
CBC Only: 11 µl  
Pre-diluted : 20 µl  
Capillary : 20 µl

### LINEARITYRANGE

WBC ( $\times 10^9/L$ ): 0 - 300  
RBC ( $\times 10^{12}/L$ ) : 0.00 - 8.50  
Hb (g/dL) : 0 - 25.0  
HCT (%) : 0 - 67  
PLT ( $\times 10^9/L$ ) : 0 - 3000

### CALIBRATOR

ELite H Cal (3mL)  
Open Vial Stability at 2-8°C: 7 Days

### TRI-LEVEL CONTROLS

Erba H5 CON L ,N, H(3mL)  
Open Vial Stability at 2-8°C: 14 Days

### THROUGHPUT

Up to 60 tests/hour

### QC (L-J, X-BAR)

Yes

### DATA STORAGE

50,000 Results With Graphs

### DIMENSIONS (MM)

364 x 498 x 431

### WEIGHT (KG)

26.5

### REAGENTS

Erba Dil (20L)  
ERBA H560 Lyse 1(200mL)  
ERBA H560 Lyse 2(500mL)  
ELite H Clean (50mL)

### INTERFACES

4 USB + 1LAN Port

### OPERATING ENVIRONMENT

15-30°C  
Atmospheric pressure  
70kPa~106kPa

### POWER REQUIREMENT

A.C.100-240V; 50/60Hz;  
≤200VA



Sole Agent in Pakistan:



www.miancorp.com

EASY.  
EFFICIENT.  
RELIABLE.

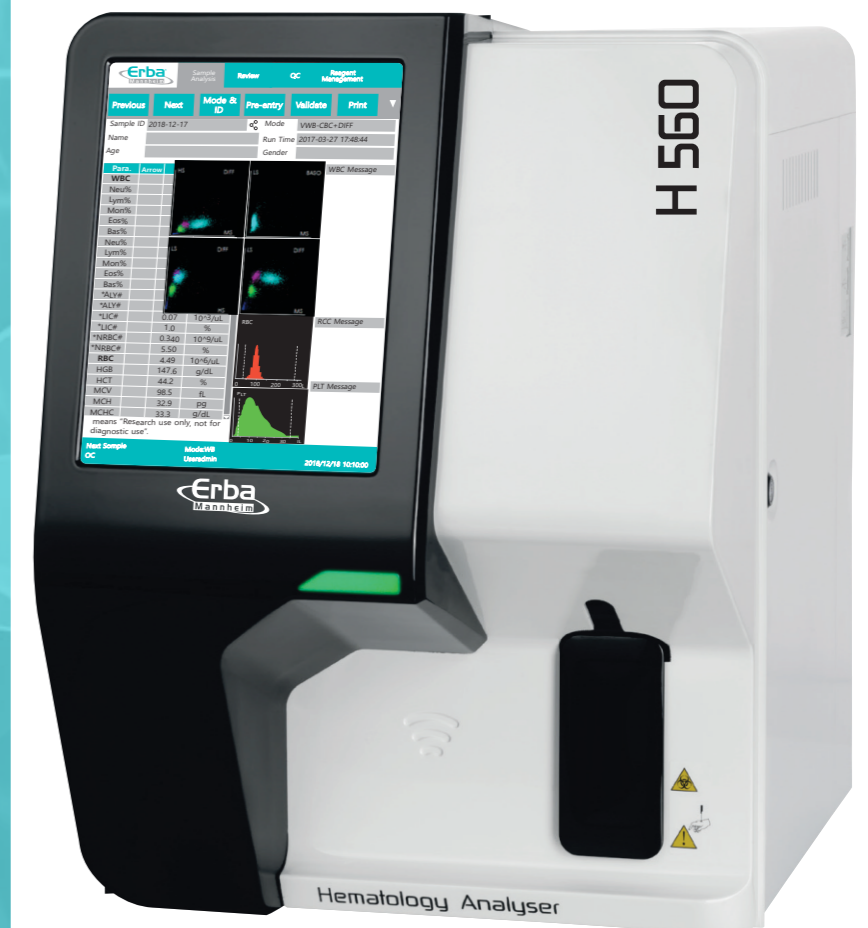

*When Less is Better  
Much Better*

# H560

FULLY AUTOMATED 5 PART  
HEMATOLOGY ANALYSER



### ERBA Diagnostics Mannheim GmbH

Mallaustrasse 69-73 68219 Mannheim, Germany  
Telephone : (+49) 621 8799770 Fax : (+49) 621 8799688  
Email : sales@erbamannheim.com Website : www.erbamannheim.com

### ERBA Lachema s.r.o.

Karásek 2219/1d, 621 00 Brno, Czech Republic  
Tel.: +420 517 077 111, fax: +420 517 077 077  
E-mail: diagnostics@erbalachema.com  
www.erbalachema.com

# EASY

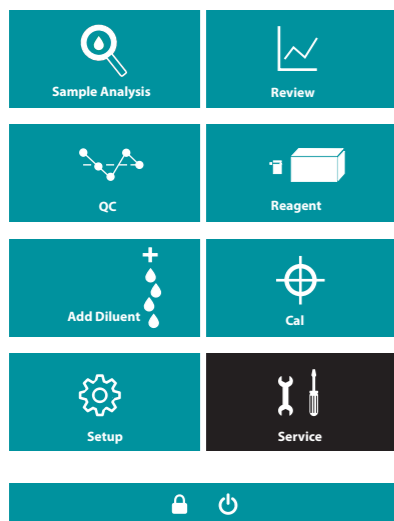

## USER INTERFACE

- 10.4" Touchscreen
- 50.000 Reports
- 4 Scatterplots (DIFF x3, BASO)
- 3 Histograms (RBC, WBC, PLT)
- 1-click analysis

## REAGENT REGISTRATION

- Full traceability via RFID inventory management system



# EFFICIENT

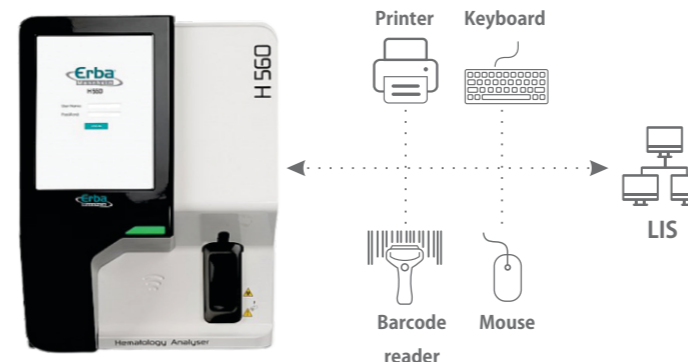

## EXTERNAL CONNECTIONS

- Low aspiration volume 15 µL
- 32 reportable parameters
- Guaranteed dilution accuracy via automatic diluent dispensing
- Advanced platelet analysis (P-LCR, P-LCC, PDW-SD, PDW-CV) Automatic floating discriminations

## ANALYTICS



# RELIABLE



## ENGINEERED CONSTRUCTION

- Small footprint - 364x498 mm
- Status indicator
- Simple, well engineered construction
- High quality components for long life

## ANTI-CLOG TECHNOLOGY

- Prevent build-up with anti-clog technology

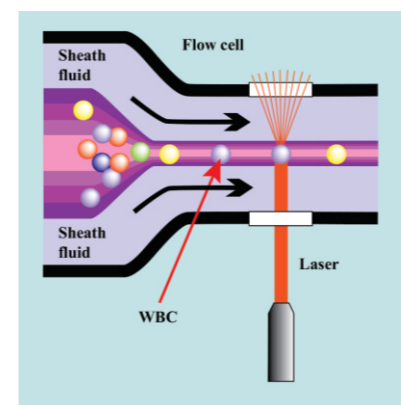

## DESIGN

- 3 Angle flow cytometry for high quality WBC differential results

